

CONSULTANTS:

SEAL:

PRELIMINARY

NOT FOR CONSTRUCTION UNLESS SIGNED & SEALED

THE ZEPF CENTER
ASHLAND FACILITY RENOVATIONS

2005 ASHLAND AVE
TOLEDO, OHIO 43620

PROJECT TITLE:

ISSUE OR REVISION:

9.21.2023 CM PROCUREMENT

DATE ISSUE / REVISION

DESIGNED: ARK

DRAWN: BLK

CHECKED: ARK

TPA COMMISSION NUMBER: 23024

DRAWING TITLE:

**CONSTRUCTION
PHASING DIAGRAM**

DRAWING NUMBER:

A1.0

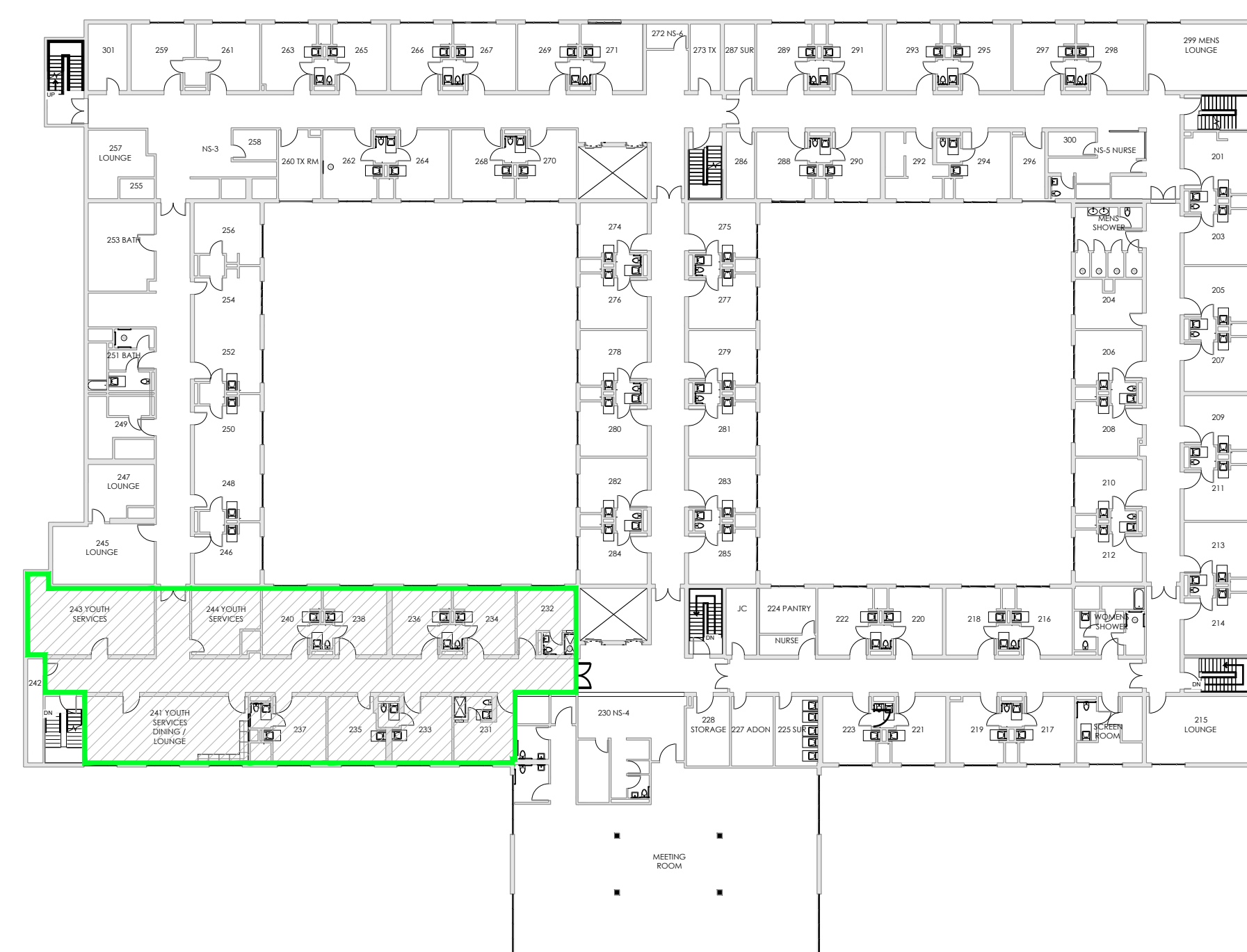
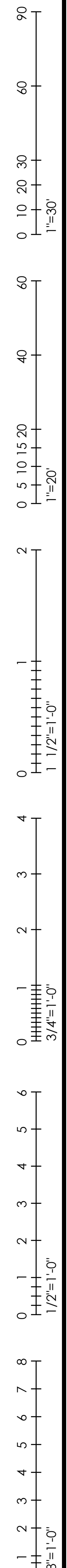

3 SECOND FLOOR CONSTRUCTION PHASING PLAN
A1.0 1/32" = 1'-0"

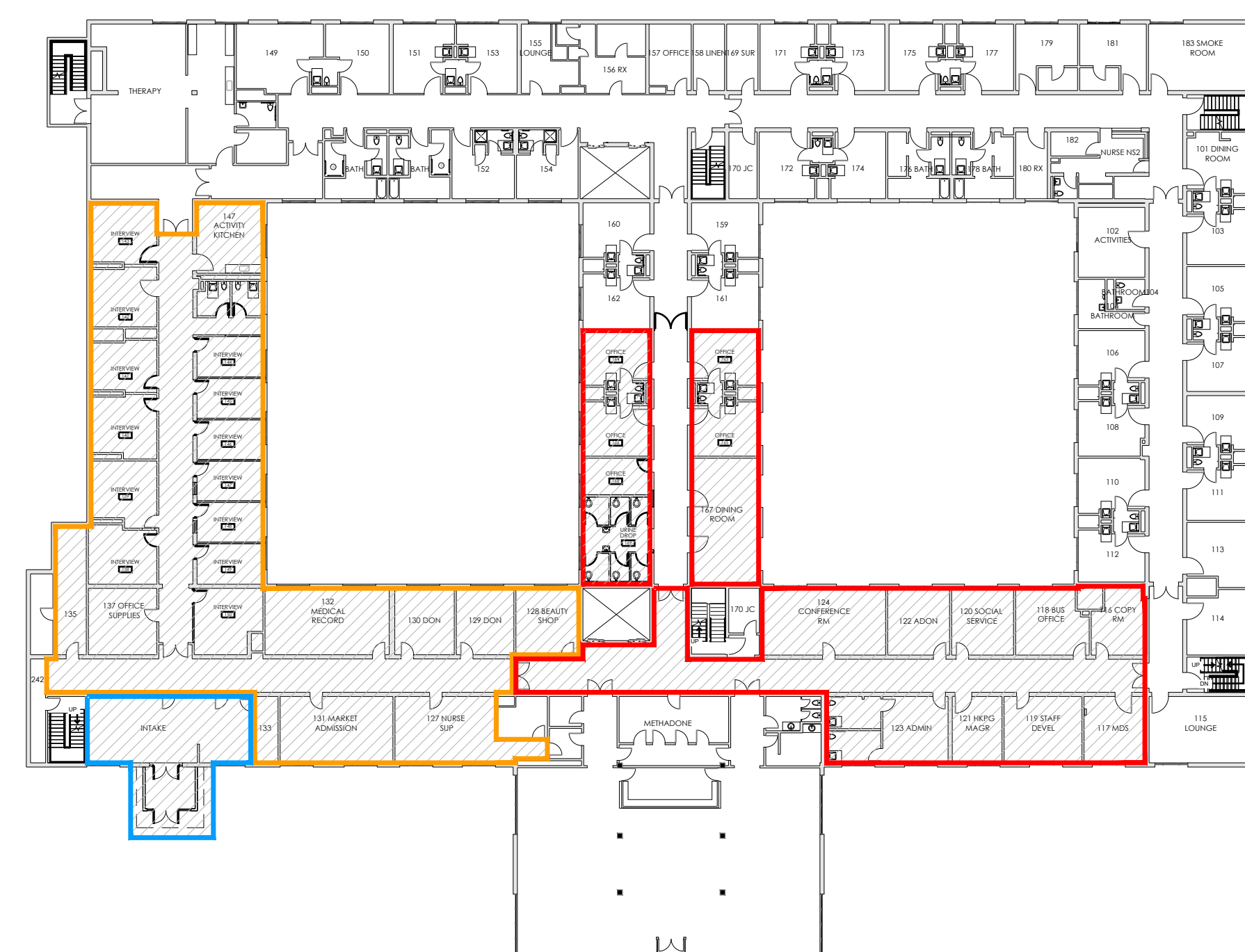

2 FIRST FLOOR CONSTRUCTION PHASING PLAN
A1.0 1/32" = 1'-0"

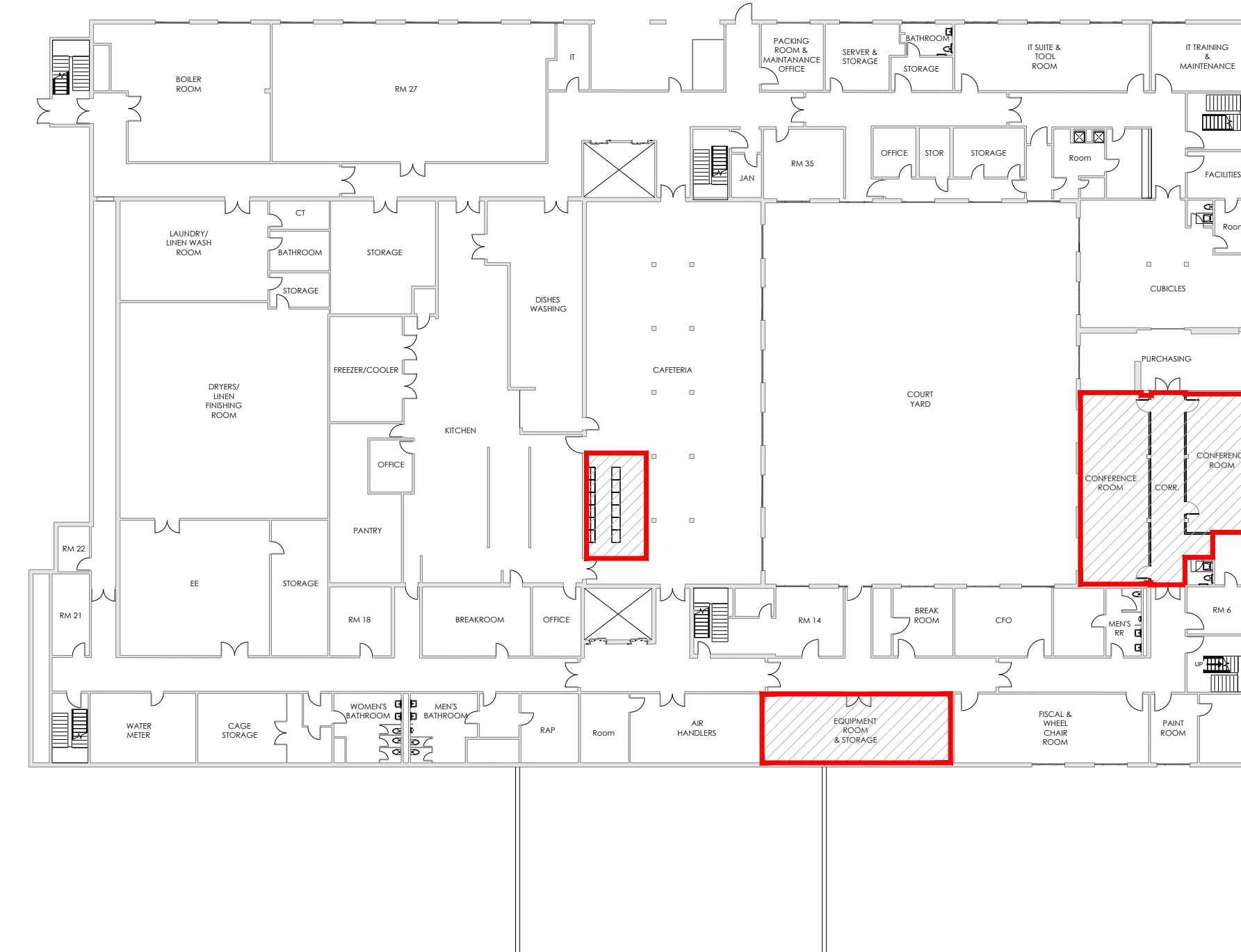

1 LOWER LEVEL CONSTRUCTION PHASING PLAN
A1.0 1/32" = 1'-0"

© 2023 THOMAS PORTER ARCHITECTS. ALL RIGHTS RESERVED. THIS DRAWING AND ALL INFORMATION HEREON ARE THE PROPERTY OF THOMAS PORTER ARCHITECTS. NO PART OF THIS DRAWING OR ANY INFORMATION HEREON MAY BE REPRODUCED OR TRANSMITTED IN ANY FORM OR BY ANY MEANS, ELECTRONIC OR MECHANICAL, WITHOUT THE WRITTEN CONSENT OF THOMAS PORTER ARCHITECTS.

CONSULTANTS:

SEAL:

PRELIMINARY

NOT FOR CONSTRUCTION UNLESS SIGNED & SEALED

90
60
30
0 10 20 30
1"=30'
60
40
20
0 5 10 15 20
1"=20'
60
40
20
0 1 2 3 4
1 1/2"=1'-0"
1
0
1 1/2"=1'-0"
4
3
2
1
0
3/4"=1'-0"
6
5
4
3
2
1
0
1 1/2"=1'-0"
8
7
6
5
4
3
2
1
0
3/8"=1'-0"

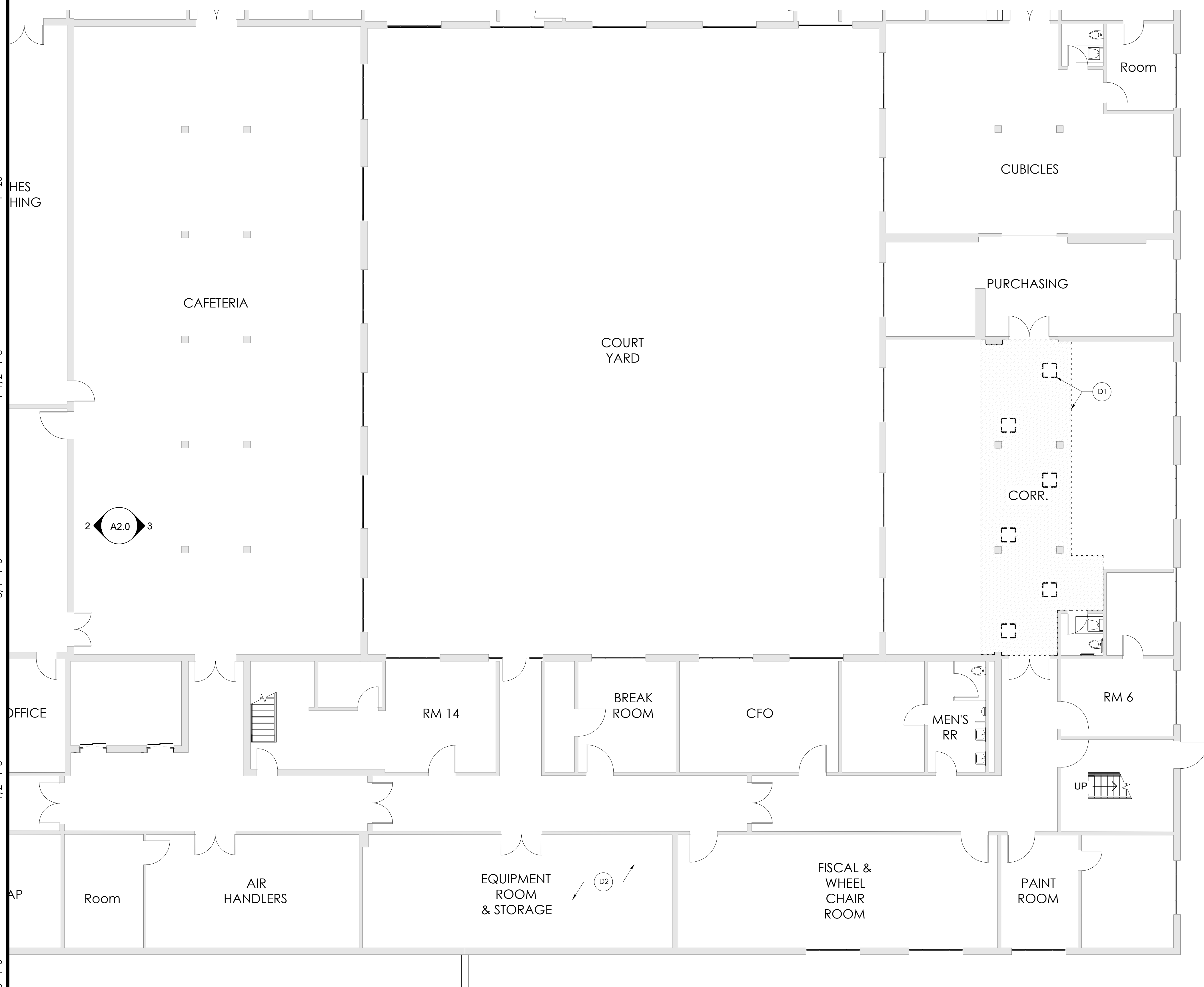

1 LOWER LEVEL DEMOLITION PLAN
D2.0 3/32" = 1'-0"

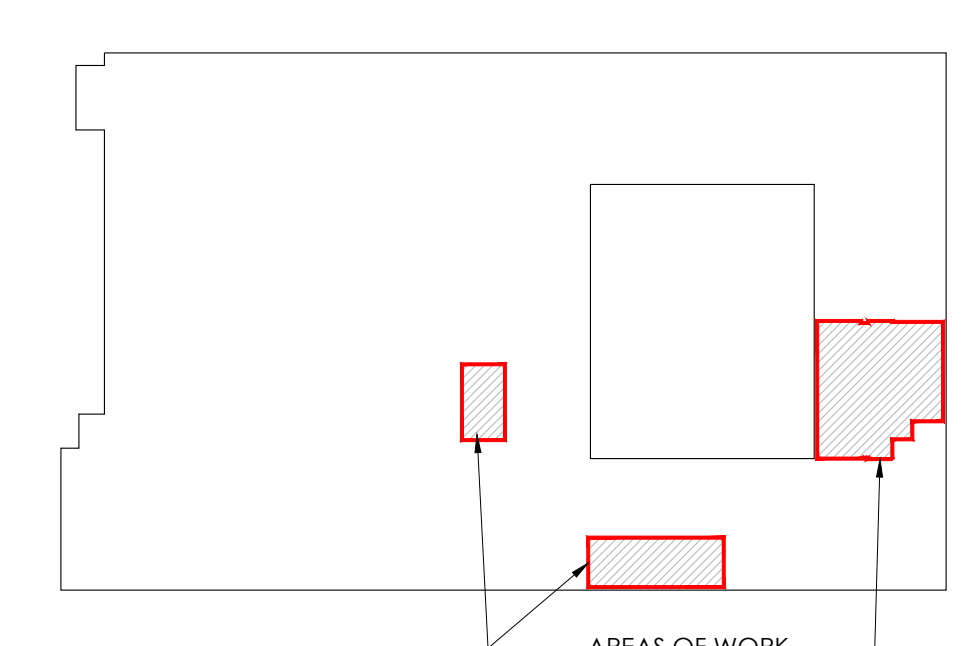

2 LOWER LEVEL KEY PLAN
D2.0 NTS

- DEMOLITION KEYED NOTES**
- D1 SELECTIVE DEMOLITION OF ACT CEILING GRID, FLOORING AND WALL BASE AS NEEDED. PREPARE FOR NEW PARTITION WALLS. CAREFULLY REMOVE AND RETAIN FOR REINSTALLATION EXISTING 2X2 LAY-IN LIGHT FIXTURES FOR NEW CORRIDOR.
 - D2 REMOVE EXISTING WALL BASE. PREPARE EXISTING 9X9 FLOORING FOR NEW LVT FLOORING TO BE INSTALLED THROUGHOUT.
 - D3 DEMO EXISTING BATHROOM FIXTURES, BATHROOM PARTITION WALLS AND ACT CEILING. PREPARE FOR NEW STUD WALLS, WALL BASE, ACT CEILING, FIXTURES AND FINISHES.
 - D4 DEMO EXISTING WALLS AND DOORS AS SEEN ON PLAN. DEMO EXISTING ACT CEILING AS NEEDED. REMOVE EXISTING WALL BASE. PREPARE FOR NEW STUD WALLS, DOORS, PAINT, WALL BASE, AND REPLACE/INSTALL NEW ACT CEILING AS NEEDED.
 - D5 DEMO EXISTING WALL AND DOORS AS SEEN ON PLAN. DEMO EXISTING ACT CEILING AS NEEDED. DEMO SELECT FIXTURES. PREPARE FOR NEW STUD WALLS, DOORS, PAINT, WALL BASE, WC, LAVATORY AND REPLACE/INSTALL NEW ACT CEILING AS NEEDED.
 - D6 DEMO EXISTING CLOSET DOOR AND STUD WALLS AS NOTED ON PLAN. REMOVE EXISTING SHOWER AND FIXTURES. PREPARE FOR NEW STUD WALL AND SHOWER.

PROJECT TITLE:

**THE ZEPF CENTER
ASHLAND FACILITY RENOVATIONS**
2005 ASHLAND AVE
TOLEDO, OHIO 43620

ISSUE OR REVISION:

DATE	ISSUE / REVISION
9.21.2023	CM PROCUREMENT

DESIGNED: ARK

DRAWN: BLK

CHECKED: ARK

TPA COMMISSION NUMBER: **23024**

DRAWING TITLE:

**LOWER LEVEL
DEMOLITION PLAN**

DRAWING NUMBER:

D2.0

© Thomas Porter Architects. All drawings and specifications are the property of Thomas Porter Architects. No part of this drawing may be reproduced, stored in a retrieval system, or transmitted in any form or by any means, electronic, mechanical, photocopying, recording, or by any information storage and retrieval system, without the prior written consent of Thomas Porter Architects.

CONSULTANTS:

SEAL:

PRELIMINARY

NOT FOR CONSTRUCTION UNLESS SIGNED & SEALED

THE ZEPF CENTER
ASHLAND FACILITY RENOVATIONS

2005 ASHLAND AVE
TOLEDO, OHIO 43620

PROJECT TITLE:

ISSUE OR REVISION:

DATE	ISSUE / REVISION
9.21.2023	CM PROCUREMENT

DESIGNED: ARK
DRAWN: BLK
CHECKED: ARK

TPA COMMISSION NUMBER: 23024

DRAWING TITLE:

**FIRST FLOOR
DEMOLITION PLAN**

DRAWING NUMBER:

D2.1

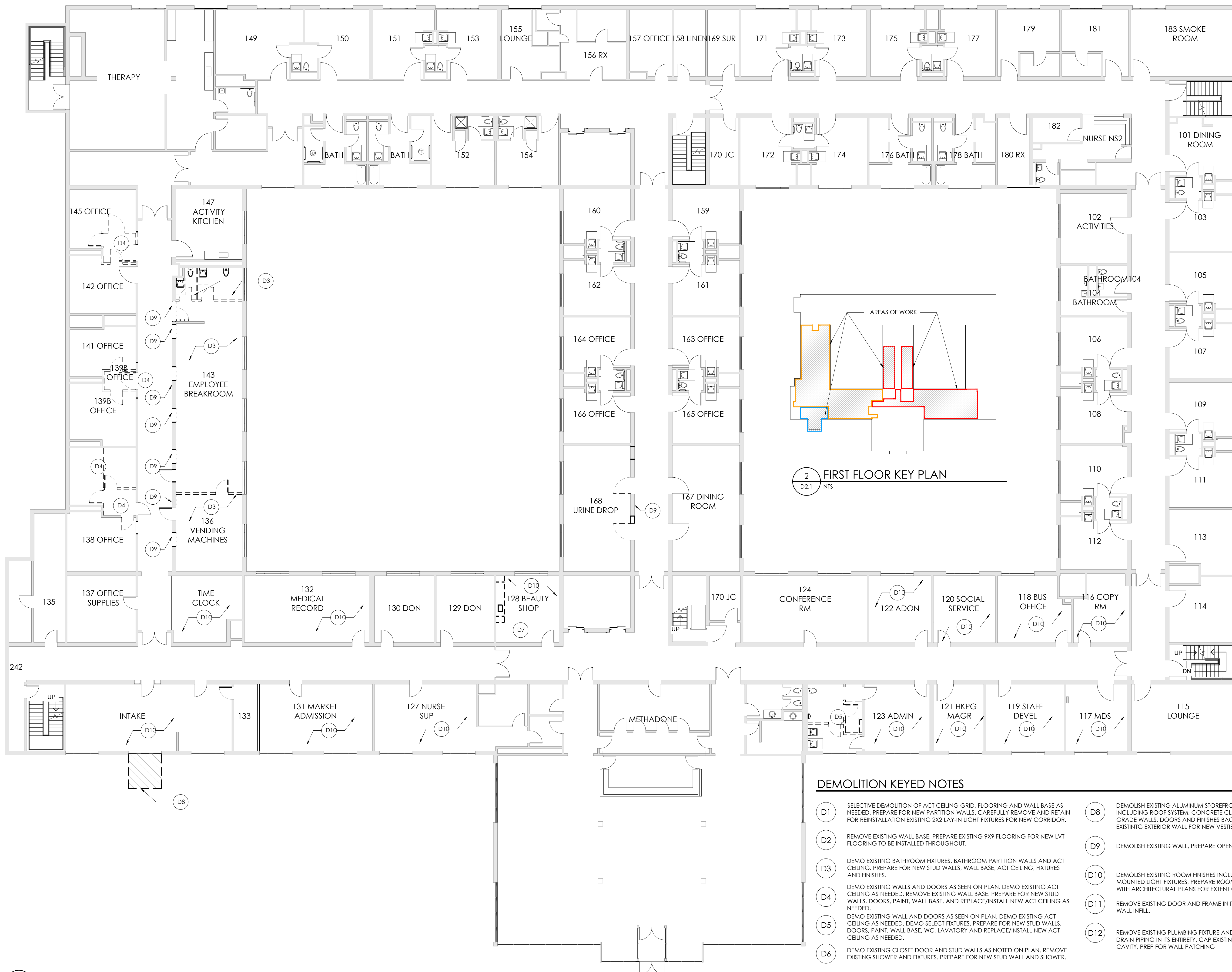

DEMOLITION KEYED NOTES

- D1** SELECTIVE DEMOLITION OF ACT CEILING GRID, FLOORING AND WALL BASE AS NEEDED. PREPARE FOR NEW PARTITION WALLS. CAREFULLY REMOVE AND RETAIN FOR REINSTALLATION EXISTING 2X2 LAY-IN LIGHT FIXTURES FOR NEW CORRIDOR.
- D2** REMOVE EXISTING WALL BASE. PREPARE EXISTING 9X9 FLOORING FOR NEW LVT FLOORING TO BE INSTALLED THROUGHOUT.
- D3** DEMO EXISTING BATHROOM FIXTURES, BATHROOM PARTITION WALLS AND ACT CEILING. PREPARE FOR NEW STUD WALLS, WALL BASE, ACT CEILING, FIXTURES AND FINISHES.
- D4** DEMO EXISTING WALLS AND DOORS AS SEEN ON PLAN. DEMO EXISTING ACT CEILING AS NEEDED. REMOVE EXISTING WALL BASE. PREPARE FOR NEW STUD WALLS, DOORS, PAINT, WALL BASE, AND REPLACE/INSTALL NEW ACT CEILING AS NEEDED.
- D5** DEMO EXISTING WALL AND DOORS AS SEEN ON PLAN. DEMO EXISTING ACT CEILING AS NEEDED. DEMO SELECT FIXTURES. PREPARE FOR NEW STUD WALLS, DOORS, PAINT, WALL BASE, WC, LAVATORY AND REPLACE/INSTALL NEW ACT CEILING AS NEEDED.
- D6** DEMO EXISTING CLOSET DOOR AND STUD WALLS AS NOTED ON PLAN. REMOVE EXISTING SHOWER AND FIXTURES. PREPARE FOR NEW STUD WALL AND SHOWER.
- D7** DEMO EXISTING CASEWORK. PREPARE ROOM FOR NEW WALL BASE, PAINT, ETC.
- D8** DEMOLISH EXISTING ALUMINUM STOREFRONT VESTIBULE IN ITS ENTIRETY INCLUDING ROOF SYSTEM, CONCRETE CLAB ON GRADE AND ALL ABOVE GRADE WALLS, DOORS AND FINISHES BACK TO BUILDING STRUCTURE. PREPARE EXISTING EXTERIOR WALL FOR NEW VESTIBULE CONSTRUCTION.
- D9** DEMOLISH EXISTING WALL, PREPARE OPENING FOR NEW DOOR OPENING.
- D10** DEMOLISH EXISTING ROOM FINISHES INCLUDING FLOORING, WALL BASE, WALL MOUNTED LIGHT FIXTURES. PREPARE ROOM FOR NEW FINISHES. COORDINATE WITH ARCHITECTURAL PLANS FOR EXTENT OF ACT CEILING REPLACEMENT.
- D11** REMOVE EXISTING DOOR AND FRAME IN ITS ENTIRETY. PREPARE OPENING FOR WALL INFILL.
- D12** REMOVE EXISTING PLUMBING FIXTURE AND ASSOCIATED CARRIERS, SUPPLY AND DRAIN PIPING IN ITS ENTIRETY. CAP EXISTING SUPPLY AND DRAIN LINES IN WALL CAVITY, PREP FOR WALL PATCHING

1 FIRST FLOOR DEMOLITION PLAN
D2.1 3/32" = 1'-0"

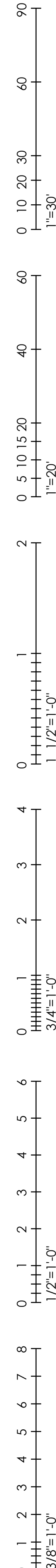

© Thomas Porter Architects. All drawings and specifications are the property of Thomas Porter Architects. No part of this drawing may be reproduced or transmitted in any form or by any means, electronic or mechanical, including photocopying, recording, or by any information storage and retrieval system, without the prior written permission of Thomas Porter Architects.

CONSULTANTS:

SEAL:

PRELIMINARY

NOT FOR CONSTRUCTION UNLESS SIGNED & SEALED

THE ZEPF CENTER
ASHLAND FACILITY RENOVATIONS

2005 ASHLAND AVE
TOLEDO, OHIO 43620

PROJECT TITLE:

ISSUE OR REVISION:

DATE	ISSUE / REVISION
9.21.2023	CM PROCUREMENT

DESIGNED: ARK
DRAWN: BLK
CHECKED: ARK

TPA COMMISSION NUMBER: 23024

DRAWING TITLE:

**SECOND FLOOR
DEMOLITION PLAN**

DRAWING NUMBER:

D2.2

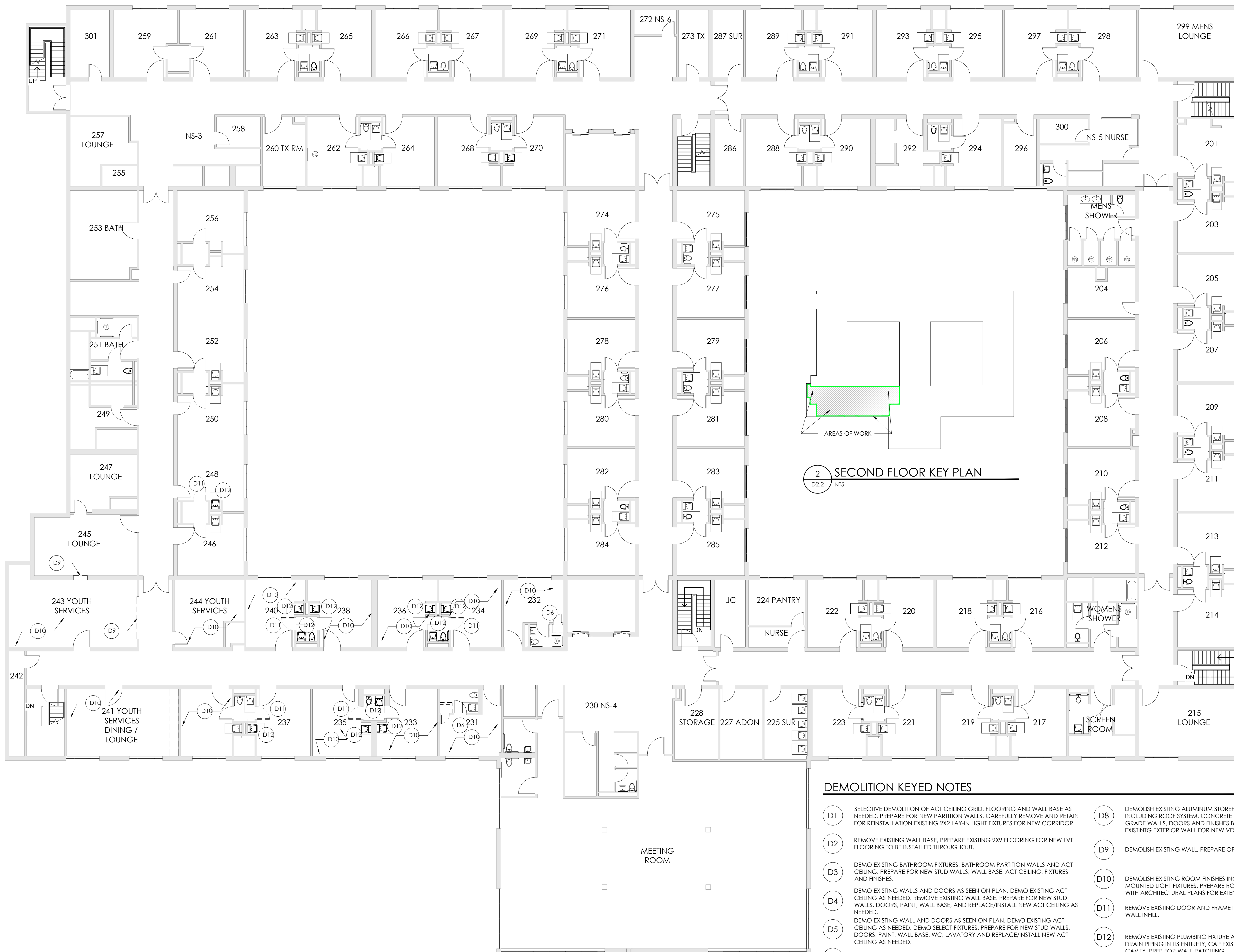

2 SECOND FLOOR KEY PLAN
D2.2 NTS

DEMOLITION KEYED NOTES

- D1** SELECTIVE DEMOLITION OF ACT CEILING GRID, FLOORING AND WALL BASE AS NEEDED. PREPARE FOR NEW PARTITION WALLS. CAREFULLY REMOVE AND RETAIN FOR REINSTALLATION EXISTING 2X2 LAY-IN LIGHT FIXTURES FOR NEW CORRIDOR.
- D2** REMOVE EXISTING WALL BASE. PREPARE EXISTING 9X9 FLOORING FOR NEW LVT FLOORING TO BE INSTALLED THROUGHOUT.
- D3** DEMO EXISTING BATHROOM FIXTURES, BATHROOM PARTITION WALLS AND ACT CEILING. PREPARE FOR NEW STUD WALLS, WALL BASE, ACT CEILING, FIXTURES AND FINISHES.
- D4** DEMO EXISTING WALLS AND DOORS AS SEEN ON PLAN. DEMO EXISTING ACT CEILING AS NEEDED. DEMO SELECT FIXTURES. PREPARE FOR NEW STUD WALLS, DOORS, PAINT, WALL BASE, AND REPLACE/INSTALL NEW ACT CEILING AS NEEDED.
- D5** DEMO EXISTING WALL AND DOORS AS SEEN ON PLAN. DEMO EXISTING ACT CEILING AS NEEDED. DEMO SELECT FIXTURES. PREPARE FOR NEW STUD WALLS, DOORS, PAINT, WALL BASE, WC, LAVATORY AND REPLACE/INSTALL NEW ACT CEILING AS NEEDED.
- D6** DEMO EXISTING CLOSET DOOR AND STUD WALLS AS NOTED ON PLAN. REMOVE EXISTING SHOWER AND FIXTURES. PREPARE FOR NEW STUD WALL AND SHOWER.
- D7** DEMO EXISTING CASEWORK. PREPARE ROOM FOR NEW WALL BASE, PAINT, ETC.
- D8** DEMOLISH EXISTING ALUMINUM STOREFRONT VESTIBULE IN ITS ENTIRETY INCLUDING ROOF SYSTEM, CONCRETE CLAB ON GRADE AND ALL ABOVE GRADE WALLS, DOORS AND FINISHES BACK TO BUILDING STRUCTURE. PREPARE EXISTING EXTERIOR WALL FOR NEW VESTIBULE CONSTRUCTION.
- D9** DEMOLISH EXISTING WALL. PREPARE OPENING FOR NEW DOOR OPENING.
- D10** DEMOLISH EXISTING ROOM FINISHES INCLUDING FLOORING, WALL BASE, WALL MOUNTED LIGHT FIXTURES. PREPARE ROOM FOR NEW FINISHES. COORDINATE WITH ARCHITECTURAL PLANS FOR EXTENT OF ACT CEILING REPLACEMENT.
- D11** REMOVE EXISTING DOOR AND FRAME IN ITS ENTIRETY. PREPARE OPENING FOR WALL INFILL.
- D12** REMOVE EXISTING PLUMBING FIXTURE AND ASSOCIATED CARRIERS, SUPPLY AND DRAIN PIPING IN ITS ENTIRETY. CAP EXISTING SUPPLY AND DRAIN LINES IN WALL CAVITY, PREP FOR WALL PATCHING

1 SECOND FLOOR DEMOLITION PLAN
D2.2 3/32" = 1'-0"

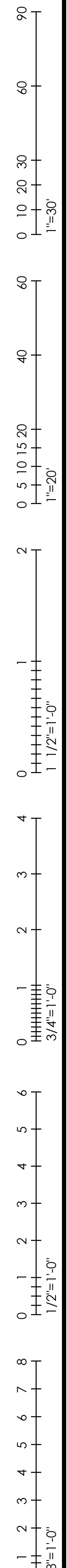

© Thomas Porter Architects. This drawing and its contents are the property of Thomas Porter Architects. It is to be used only for the project and location specified on the title block. It is not to be reproduced, stored in a retrieval system, or transmitted in any form or by any means, electronic, mechanical, photocopying, recording, or by any information storage and retrieval system, without the prior written consent of Thomas Porter Architects.

CONSULTANTS:

SEAL:

PRELIMINARY

NOT FOR CONSTRUCTION UNLESS SIGNED & SEALED

THE ZEPF CENTER
ASHLAND FACILITY RENOVATIONS

2005 ASHLAND AVE
TOLEDO, OHIO 43620

PROJECT TITLE:

ISSUE OR REVISION:

DATE	ISSUE / REVISION
9.21.2023	CM PROCUREMENT

DESIGNED: ARK

DRAWN: BLK

CHECKED: ARK

TPA COMMISSION NUMBER: 23024

DRAWING TITLE:

LOWER LEVEL
DEMOLITION PLAN

DRAWING NUMBER:

A2.0

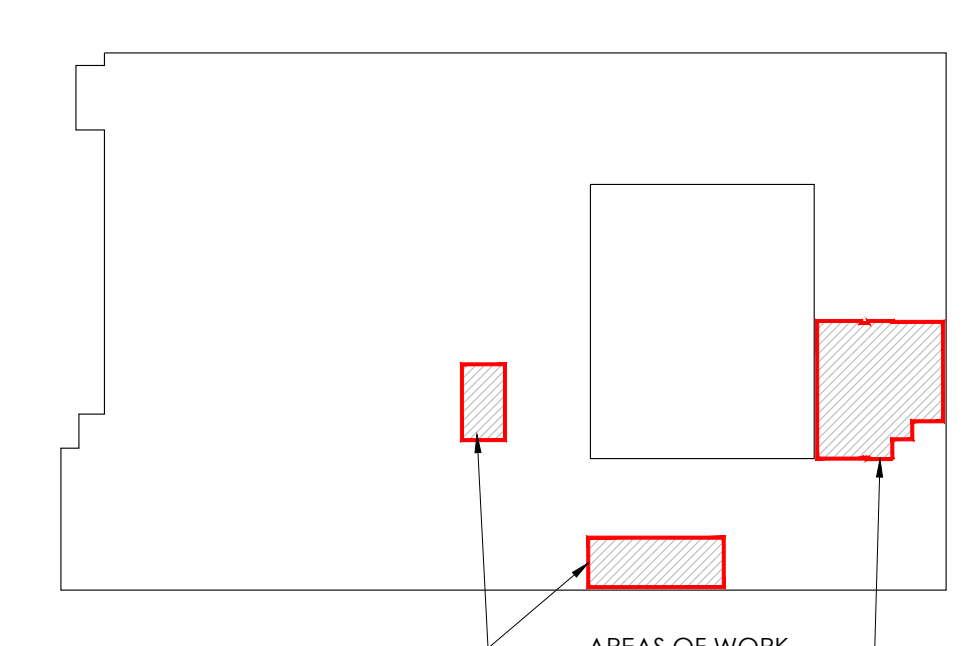
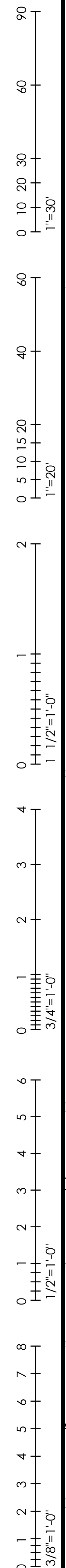

4 LOWER LEVEL KEY PLAN
A2.0 NTS

- 1. NEW LVT OR VCT FLOORING, NEW RUBBER WALL BASE.
2. PREP/PRIME/PAINT WALLS IN THEIR ENTIRETY.
3. NEW ACT GRID WITH NEW LED LAY-IN FIXTURE.
- 1. EXISTING FLOORING TO REMAIN, NEW RUBBER WALL BASE.
2. PREP/PRIME/PAINT WALLS IN THEIR ENTIRETY.
3. PREP/PRIME/PAINT EXISTING ACT GRID, REPLACE DAMAGED ACT CEILING TILE, EXISTING LAY-IN LIGHT FIXTURES TO REMAIN AS IS.
- 1. EXISTING FLOORING TO REMAIN, NEW RUBBER WALL BASE.
2. PREP/PRIME/PAINT WALLS IN THEIR ENTIRETY.
3. PREP/PRIME/PAINT EXISTING ACT GRID, REPLACE DAMAGED ACT CEILING TILE, REMOVE EXISTING WALL MOUNTED LIGHT FIXTURES & PROVIDE NEW LED LAY-IN FIXTURES IN EXISTING ACT GRID.
- 1. NEW LVT FLOORING, NEW RUBBER WALL BASE.
2. PREP/PRIME/PAINT WALLS IN THEIR ENTIRETY.
3. NEW ACT GRID WITH NEW LED LAY-IN LIGHT FIXTURES.
4. ADD HVAC EQUIP/DISTRIBUTION/THERMOSTAT FOR TEMP CONTROL.
- 1. NEW LVT OR VCT FLOORING, NEW RUBBER WALL BASE.
2. PREP/PRIME/PAINT WALLS IN THEIR ENTIRETY.
3. PREP/PRIME/PAINT EXISTING ACT GRID, REPLACE DAMAGED ACT CEILING TILE, EXISTING LAY-IN LIGHT FIXTURES TO REMAIN AS IS.
- 1. EXISTING FLOORING TO REMAIN, NEW RUBBER WALL BASE.
2. PREP/PRIME/PAINT WALLS IN THEIR ENTIRETY.
3. REWORK / SELECTIVE REPLACEMENT OF ACT GRID, EXISTING LAY-IN FIXTURES TO REMAIN.
- 1. EXISTING FLOORING TO REMAIN, NEW RUBBER WALL BASE.
2. PREP/PRIME/PAINT WALLS IN THEIR ENTIRETY.
3. NEW ACT GRID WITH NEW LED LAY-IN FIXTURE.

KEYED PLAN NOTES

- 1 NEW LVT FLOOR INSTALLED OVER EXISTING 9X9 FLOORING, NEW WALL BASE AND PAINT, PAINT EXISTING ACT CEILING GRID.
- 2 NEW STUD WALLS AND DOORWAYS, NEW PAINT AND WALL BASE AS NEEDED, REINSTALL EXISTING 2X2 LIGHT FIXTURES INTO NEW CORRIDOR, NEW ACT CEILING AS NEEDED, REPAINT EXISTING TO REMAIN ACT CEILING GRID.
- 3 NEW SERVING KITCHEN, 36" BASE, WALL CABINETS, AND ISLAND.
- 4 NEW STUD WALL, DOOR AND FRAME, PRIME/PAINT AND WALL BASE TO MATCH EXISTING.
- 5 NEW STUD WALL, NEW WATERCLOSET, LAVATORY AND ACCESSORIES, NEW ACT CEILING AS NEEDED, ADDITIONAL ROOM IMPROVEMENTS AS NOTED BY COLOR CODE.
- 6 NEW STUD WALLS AND DOORWAYS, NEW PAINT AND WALL BASE AS NEEDED, REINSTALL EXISTING 2X2 LIGHT FIXTURES INTO NEW CORRIDOR, NEW ACT CEILING AS NEEDED, REPAINT EXISTING TO REMAIN ACT CEILING GRID.
- 7 NEW STUD WALLS AND DOORWAYS, NEW ACT CEILING, WATER CLOSETS, LAVATORIES AND FINISHES.
- 8 NEW DOOR AND FRAME IN EXISTING STUD WALL.
- 9 NEW STUD WALL, SHOWER PAN, PLUMBING FIXTURES AND ACCESSORIES, ADDITIONAL ROOM IMPROVEMENT AS NOTED BY COLOR CODE.
- 10 NEW FLOORING, NEW WALL BASE, PAINT WALLS, NEW ACT GRID CEILINGS, NEW LED 2X2 LIGHT FIXTURES.
- 11 NEW SECURE INTAKE ENTRANCE VESTIBULE, CONC. SLAB ON GRADE, LIGHT GAUGE WALL FRAMING WITH ARCHITECTURAL METAL PANELIZED EXTERIOR FINISH, COLD FORMED ROOF FRAMING WITH MEMBRANE ROOFING.

1 LOWER LEVEL DEMOLITION PLAN
A2.0 3/32" = 1'-0"

CONSULTANTS:

SEAL:

PRELIMINARY

NOT FOR CONSTRUCTION UNLESS SIGNED & SEALED

THE ZEPF CENTER
ASHLAND FACILITY RENOVATIONS

2005 ASHLAND AVE
TOLEDO, OHIO 43620

PROJECT TITLE:

ISSUE OR REVISION:

9.21.2023 CM PROCUREMENT

DATE ISSUE / REVISION

DESIGNED: ARK

DRAWN: BLK

CHECKED: ARK

TPA COMMISSION NUMBER: 23024

DRAWING TITLE:

FIRST FLOOR
PROPOSED PLAN

DRAWING NUMBER:

A2.1

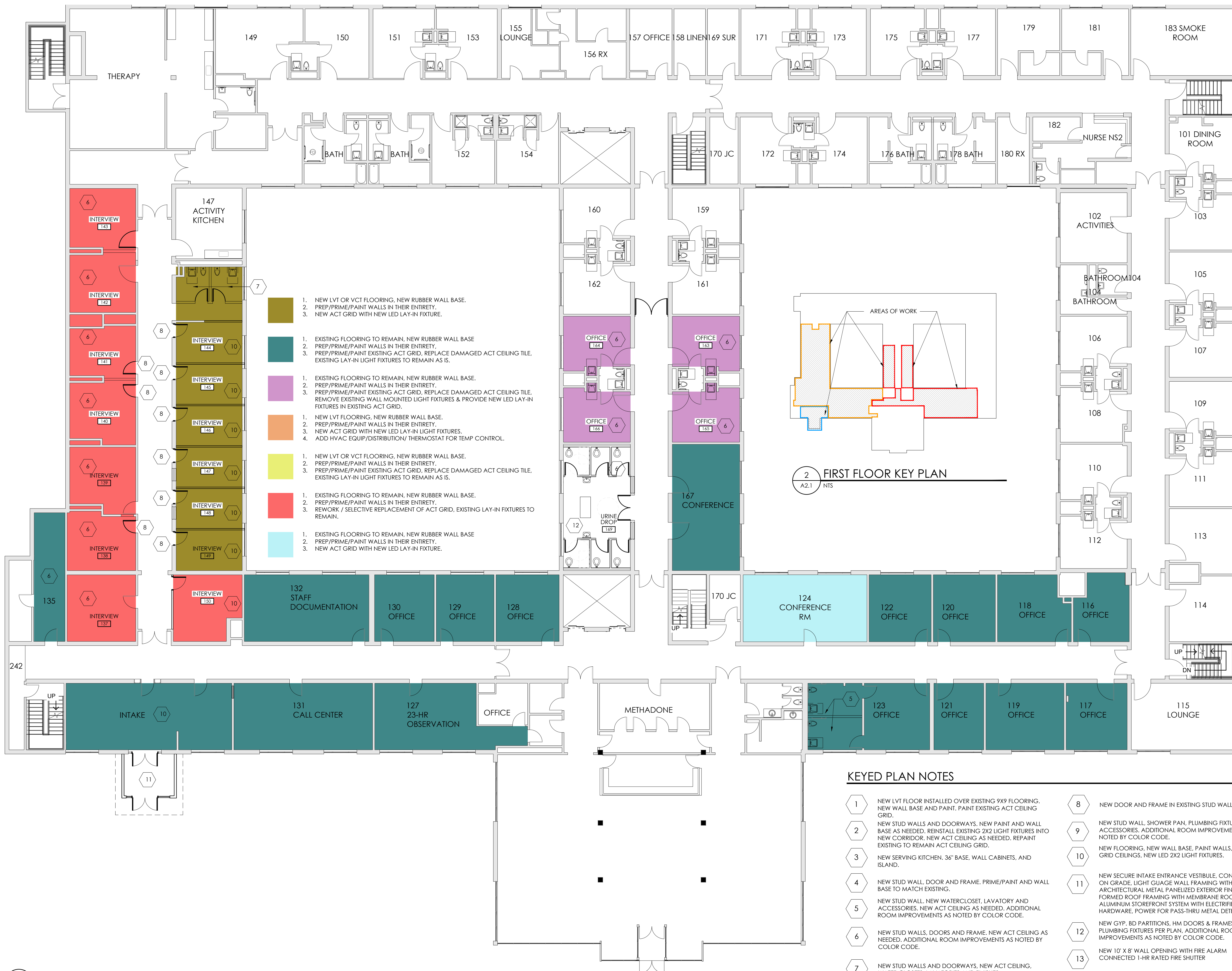

- 1. NEW LVT OR VCT FLOORING, NEW RUBBER WALL BASE.
2. PREP/PRIME/PAINT WALLS IN THEIR ENTIRETY.
3. NEW ACT GRID WITH NEW LED LAY-IN FIXTURE.
- 1. EXISTING FLOORING TO REMAIN, NEW RUBBER WALL BASE
2. PREP/PRIME/PAINT WALLS IN THEIR ENTIRETY.
3. PREP/PRIME/PAINT EXISTING ACT GRID, REPLACE DAMAGED ACT CEILING TILE, EXISTING LAY-IN LIGHT FIXTURES TO REMAIN AS IS.
- 1. EXISTING FLOORING TO REMAIN, NEW RUBBER WALL BASE.
2. PREP/PRIME/PAINT WALLS IN THEIR ENTIRETY.
3. PREP/PRIME/PAINT EXISTING ACT GRID, REPLACE DAMAGED ACT CEILING TILE, REMOVE EXISTING WALL MOUNTED LIGHT FIXTURES & PROVIDE NEW LED LAY-IN FIXTURES IN EXISTING ACT GRID.
- 1. NEW LVT FLOORING, NEW RUBBER WALL BASE.
2. PREP/PRIME/PAINT WALLS IN THEIR ENTIRETY.
3. NEW ACT GRID WITH NEW LED LAY-IN LIGHT FIXTURES.
4. ADD HVAC EQUIP/DISTRIBUTION/ THERMOSTAT FOR TEMP CONTROL.
- 1. NEW LVT OR VCT FLOORING, NEW RUBBER WALL BASE.
2. PREP/PRIME/PAINT WALLS IN THEIR ENTIRETY.
3. PREP/PRIME/PAINT EXISTING ACT GRID, REPLACE DAMAGED ACT CEILING TILE, EXISTING LAY-IN LIGHT FIXTURES TO REMAIN AS IS.
- 1. EXISTING FLOORING TO REMAIN, NEW RUBBER WALL BASE.
2. PREP/PRIME/PAINT WALLS IN THEIR ENTIRETY.
3. REWORK / SELECTIVE REPLACEMENT OF ACT GRID, EXISTING LAY-IN FIXTURES TO REMAIN.
- 1. EXISTING FLOORING TO REMAIN, NEW RUBBER WALL BASE
2. PREP/PRIME/PAINT WALLS IN THEIR ENTIRETY.
3. NEW ACT GRID WITH NEW LED LAY-IN FIXTURE.

2 FIRST FLOOR KEY PLAN
A2.1 NTS

KEYED PLAN NOTES

- 1 NEW LVT FLOOR INSTALLED OVER EXISTING 9X9 FLOORING, NEW WALL BASE AND PAINT, PAINT EXISTING ACT CEILING GRID.
- 2 NEW STUD WALLS AND DOORWAYS, NEW PAINT AND WALL BASE AS NEEDED, REINSTALL EXISTING 2X2 LIGHT FIXTURES INTO NEW CORRIDOR, NEW ACT CEILING AS NEEDED, REPAINT EXISTING TO REMAIN ACT CEILING GRID.
- 3 NEW SERVING KITCHEN, 36" BASE, WALL CABINETS, AND ISLAND.
- 4 NEW STUD WALL, DOOR AND FRAME, PRIME/PAINT AND WALL BASE TO MATCH EXISTING.
- 5 NEW STUD WALL, NEW WATERCLOSET, LAVATORY AND ACCESSORIES, NEW ACT CEILING AS NEEDED, ADDITIONAL ROOM IMPROVEMENTS AS NOTED BY COLOR CODE.
- 6 NEW STUD WALLS, DOORS AND FRAME, NEW ACT CEILING AS NEEDED, ADDITIONAL ROOM IMPROVEMENTS AS NOTED BY COLOR CODE.
- 7 NEW STUD WALLS AND DOORWAYS, NEW ACT CEILING, WATER CLOSETS, LAVATORIES AND FINISHES.
- 8 NEW DOOR AND FRAME IN EXISTING STUD WALL
- 9 NEW STUD WALL, SHOWER PAN, PLUMBING FIXTURES AND ACCESSORIES, ADDITIONAL ROOM IMPROVEMENT AS NOTED BY COLOR CODE.
- 10 NEW FLOORING, NEW WALL BASE, PAINT WALLS, NEW ACT GRID CEILINGS, NEW LED 2X2 LIGHT FIXTURES.
- 11 NEW SECURE INTAKE ENTRANCE VESTIBULE, CONC. SLAB ON GRADE, LIGHT GUAGE WALL FRAMING WITH ARCHITECTURAL METAL PANELIZED EXTERIOR FINISH, COLD FORMED ROOF FRAMING WITH MEMBRANE ROOFING, ALUMINUM STOREFRONT SYSTEM WITH ELECTRIFIED DOOR HARDWARE, POWER FOR PASS-THRU METAL DETECTORS.
- 12 NEW GYP. BD PARTITIONS, HM DOORS & FRAMES, NEW PLUMBING FIXTURES PER PLAN, ADDITIONAL ROOM IMPROVEMENTS AS NOTED BY COLOR CODE.
- 13 NEW 10' X 8' WALL OPENING WITH FIRE ALARM CONNECTED 1-HR RATED FIRE SHUTTER

1 FIRST FLOOR DEMOLITION PLAN
A2.1 3/32" = 1'-0"

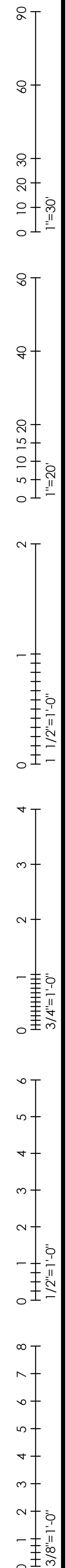

© Thomas Porter Architects. This drawing and its contents are the property of Thomas Porter Architects. It is to be used only for the project and location specified on the title block. It is not to be reproduced, stored in a retrieval system, or transmitted in any form or by any means, electronic, mechanical, photocopying, recording, or by any information storage and retrieval system, without the prior written permission of Thomas Porter Architects.

CONSULTANTS:

SEAL:

PRELIMINARY

NOT FOR CONSTRUCTION UNLESS SIGNED & SEALED

THE ZEPF CENTER
ASHLAND FACILITY RENOVATIONS

2005 ASHLAND AVE
TOLEDO, OHIO 43620

PROJECT TITLE:

ISSUE OR REVISION:

DATE	ISSUE / REVISION
9.21.2023	CM PROCUREMENT

DESIGNED: ARK

DRAWN: BLK

CHECKED: ARK

TPA COMMISSION NUMBER: 23024

DRAWING TITLE:

SECOND FLOOR
PROPOSED PLAN

DRAWING NUMBER:

A2.2

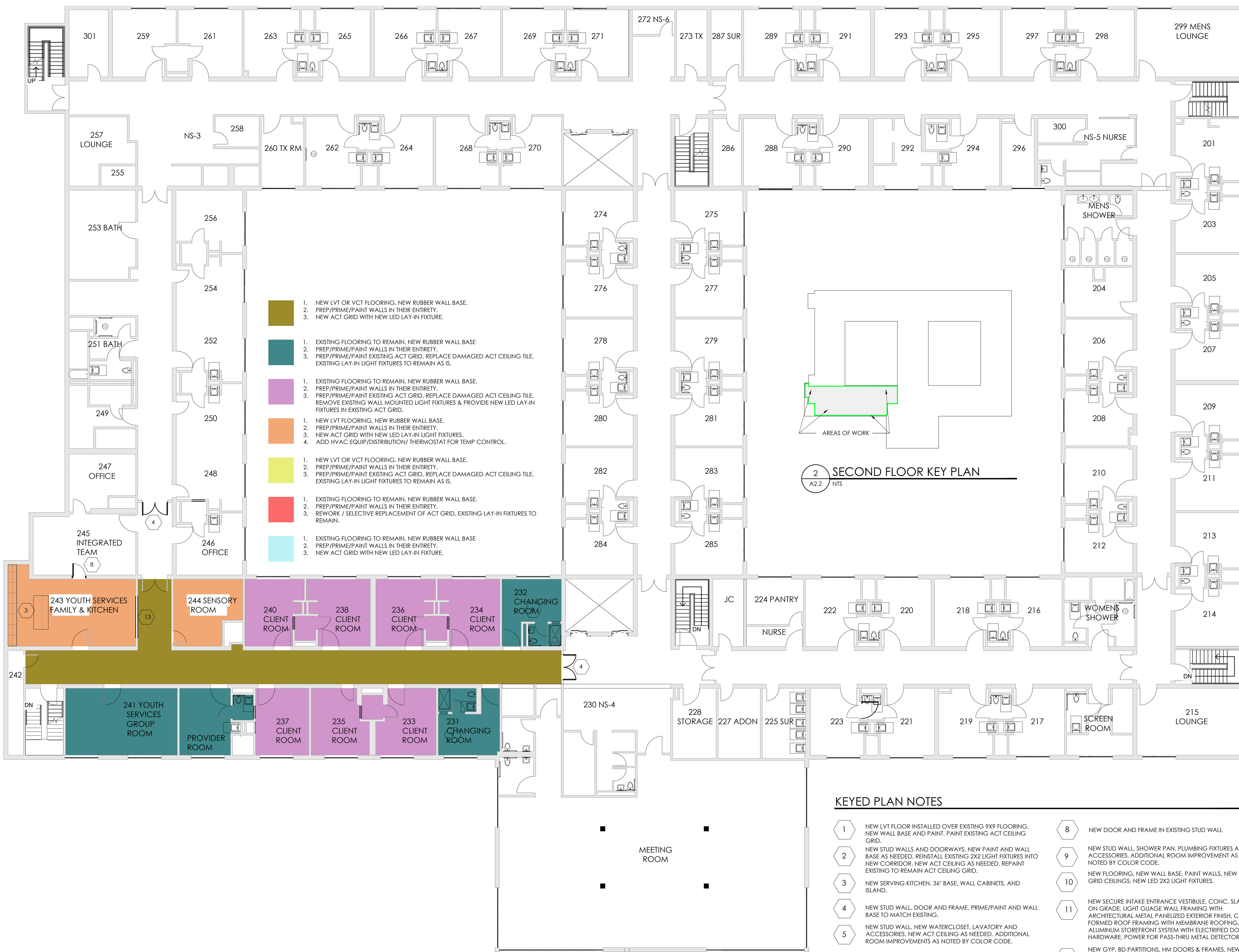

2 SECOND FLOOR KEY PLAN
A2.2 INTS

KEYED PLAN NOTES

- | | |
|---|---|
| 1. NEW LVT FLOOR INSTALLED OVER EXISTING 9X9 FLOORING. NEW WALL BASE AND PAINT. PAINT EXISTING ACT CEILING GRID. | 8. NEW DOOR AND FRAME IN EXISTING STUD WALL |
| 2. NEW STUD WALLS AND DOORWAYS. NEW PAINT AND WALL BASE AS NEEDED. REINSTALL EXISTING 2X2 LIGHT FIXTURES INTO NEW CORRIDOR. NEW ACT CEILING AS NEEDED. REPAINT EXISTING TO REMAIN ACT CEILING GRID. | 9. NEW STUD WALL, SHOWER PAN, PLUMBING FIXTURES AND ACCESSORIES. ADDITIONAL ROOM IMPROVEMENT AS NOTED BY COLOR CODE. |
| 3. NEW SERVING KITCHEN. 36" BASE, WALL CABINETS, AND ISLAND. | 10. NEW FLOORING, NEW WALL BASE, PAINT WALLS, NEW ACT GRID CEILINGS, NEW LED 2X2 LIGHT FIXTURES. |
| 4. NEW STUD WALL, DOOR AND FRAME, PRIME/PAINT AND WALL BASE TO MATCH EXISTING. | 11. NEW SECURE INTAKE ENTRANCE VESTIBULE. CONC. SLAB ON GRADE, LIGHT GUAGE WALL FRAMING WITH ARCHITECTURAL METAL PANELIZED EXTERIOR FINISH, COLD FORMED ROOF FRAMING WITH MEMBRANE ROOFING, ALUMINUM STOREFRONT SYSTEM WITH ELECTRIFIED DOOR HARDWARE, POWER FOR PASS-THRU METAL DETECTORS. |
| 5. NEW STUD WALL, NEW WATERCLOSET, LAVATORY AND ACCESSORIES. NEW ACT CEILING AS NEEDED. ADDITIONAL ROOM IMPROVEMENTS AS NOTED BY COLOR CODE. | 12. NEW GYP. BD PARTITIONS, HM DOORS & FRAMES, NEW PLUMBING FIXTURES PER PLAN, ADDITIONAL ROOM IMPROVEMENTS AS NOTED BY COLOR CODE. |
| 6. NEW STUD WALLS, DOORS AND FRAME, NEW ACT CEILING AS NEEDED. ADDITIONAL ROOM IMPROVEMENTS AS NOTED BY COLOR CODE. | 13. NEW 10' X 8' WALL OPENING WITH FIRE ALARM CONNECTED 1-HR RATED FIRE SHUTTER |
| 7. NEW STUD WALLS AND DOORWAYS. NEW ACT CEILING, WATER CLOSETS, LAVATORIES AND FINISHES. | |

1 SECOND FLOOR DEMOLITION PLAN
A2.2 3/32" = 1'-0"

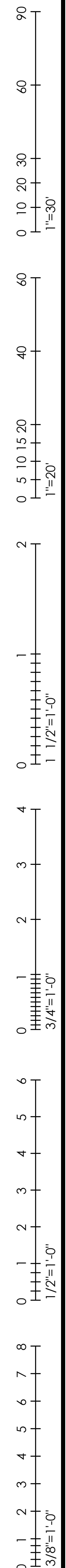

© Thomas Porter Architects. All drawings and specifications are the property of Thomas Porter Architects. No part of this drawing may be reproduced or transmitted in any form or by any means, electronic or mechanical, including photocopying, recording, or by any information storage and retrieval system, without the prior written permission of Thomas Porter Architects.